

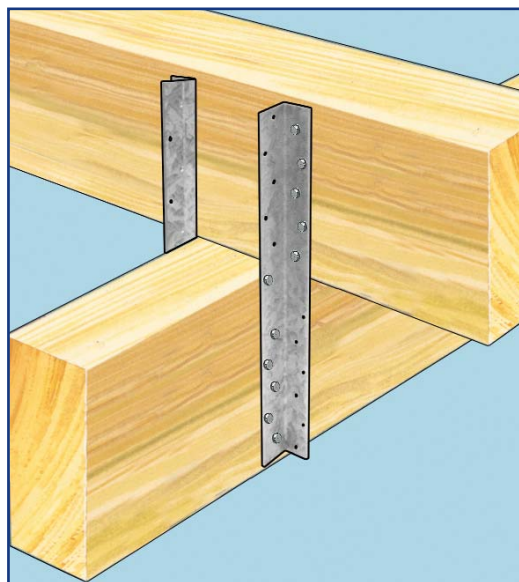

FIXINGS

ANGLE PLATE



300mm x 300mm

QTY PER BOX
50

BAT Angle Plates are used as a safe and economical method of connecting joints to purlins.

DESIGN FEATURES

- Manufactured from 2mm thick hot dipped pregalvinised mild steel to BS EN 10142 : 1991, DX51D + Z275
- Safe working loads: 1 pair = 3.5kN
2 pairs = 7.5kN

Ref: AP30030

300mm x 30mm x 30mm

INSTALLATION REQUIREMENTS

Fixing: Use BAT 3.75 x 30mm long square twisted sheradised nails.

Use all timber facing nail holes.

Minimum timber depth of 150mm.

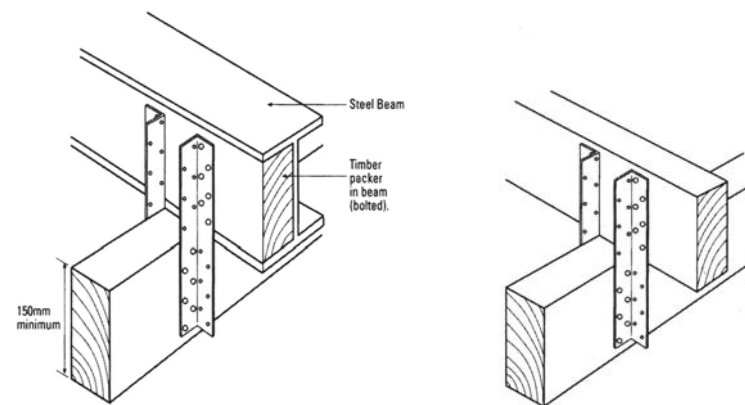

Galtee Valley Enterprise Park, Ballylanders, Co. Limerick
Tel: 062 46290, Fax: 062 46291, E-mail: info@batmetalwork.com

www.batmetalwork.com